

Rev	Date	Iss. By	App. By	Description
P01	13/08/25	KH	RS	First Issue
P02	18/08/25	RS	RS	Accommodation schedule updated
P03	01/10/25	RS	RS	Updates in accordance with comments received

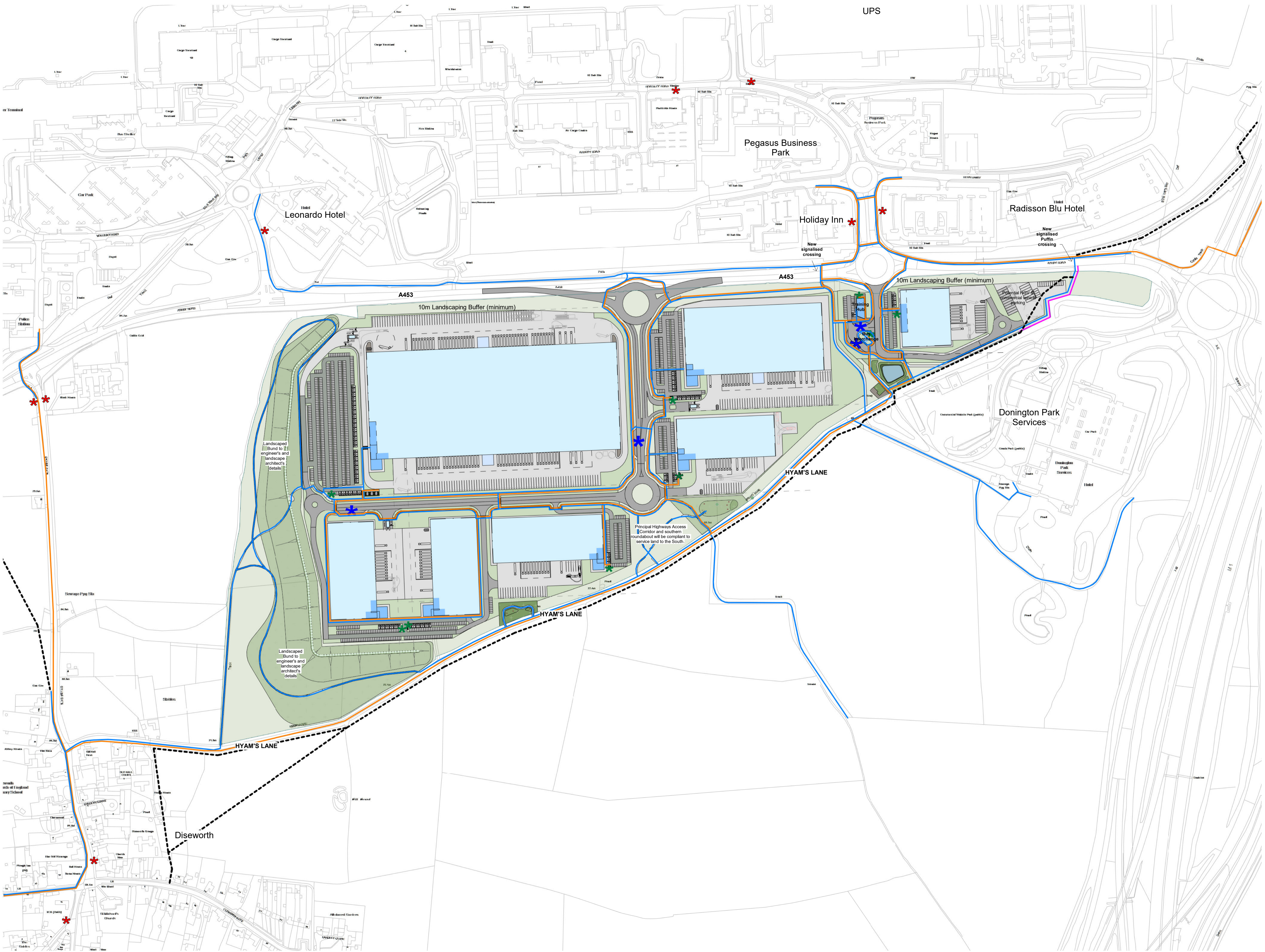

- KEY**
- Cycle Travel Route
 - Pedestrian Travel Route
 - Proposed Diverted Public Right of Way (indicative alignment) - footpath only
 - - - Existing Public Right of Way - footpath only
 - * Proposed Bus Stop
 - * Existing Bus Stop
 - * Cycle Store



SGP

Architects + Masterplanners

Prologis House,
Blythe Gate,
Blythe Valley Park,
Solihull, B90 8AH

t: +44 (0)121 711 6929

www.stephengeorge.co.uk

Prologis
MAG EMA
Castle Donnington

Drawing Name:
Access Plan

Drawing Stage: Feasibility

Status: S0

SGP File Ref: 25-060-SGP_XX_XX_M3_A_0020

25-060 13/08/25 KH RS As indicated @ A1 P03
SGP Project No Date Draw Team Scale Rev
Drawing Number: Project-Originator-Functional-Spatial-Form-Description-Number

25-060-SGP-MP-ZZ-DR-A- 001015

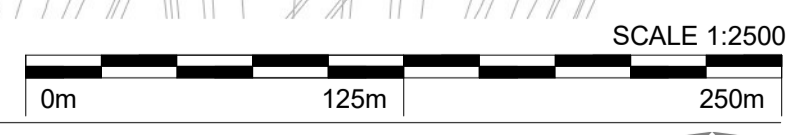

3 Illustrative Access Plan

1 : 2500

This drawing, the works and concepts depicted are copyright of Stephen George + Partners LLP and may not be reproduced or made use of, either directly or indirectly without express written consent. All heights, levels, sizes and dimensions to be checked on site before any work is put to hand. Information shown on this drawing that is produced by others has not been verified by Stephen George + Partners LLP and no liability is accepted for its accuracy. This document is prepared for the sole use of the documented recipient and Stephen George + Partners LLP accepts no liability for use of this document by parties other than the party for whom it was prepared or for purposes other than those for which it was prepared.